

# OEM Product

## Fast Load Pump Head DZ25-3L(PPS)

### OEM-B501/DZ25-3L(servo motor)

Dimension Drawing(Unit: mm)

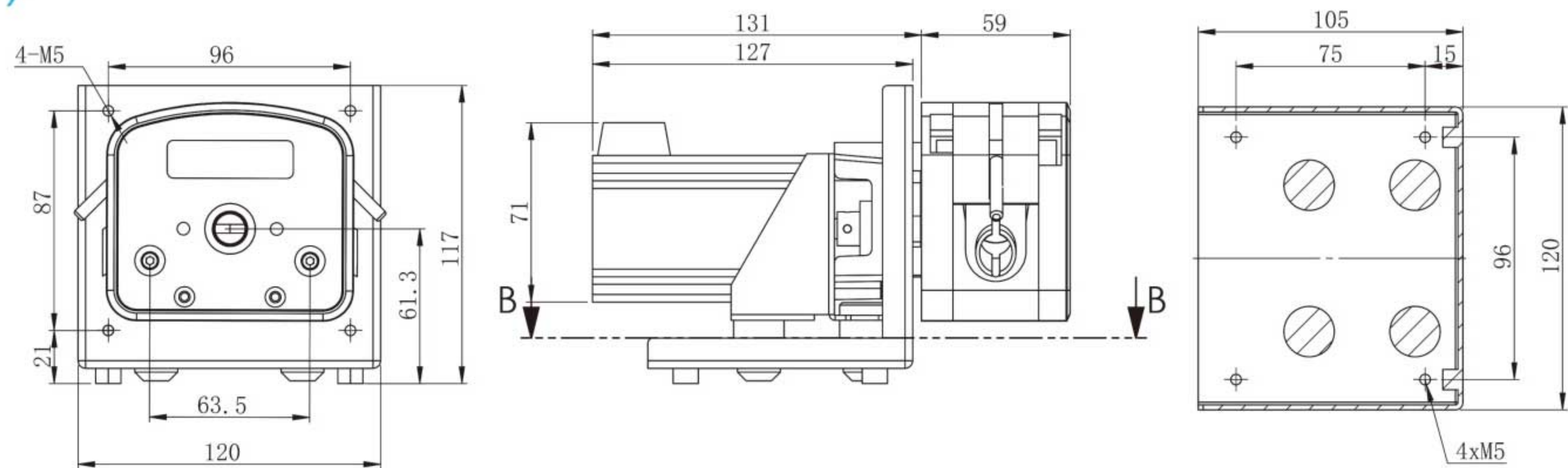

### OEM-B19 Technical Specifications

Speed range	0.1-600 rpm	External control start and stop	Switch signal (default 5V)
Speed control	Digital knob(Optional)	External control speed	0-5V, 4-20mA(standard), 0-10V(optional)
Display	OLED(Optional)	Communication interface	RS485(Modbus protocol, RTU mode)
Control method	Toggle switch control start and stop, direction (optional)	Motor type	Servo motor
		Voltage	DC24V/1A(mainboard) DC36V/3A(driver)

### OEM-Z402/DZ25-3L(DC motor)

Dimension Drawing(Unit: mm)

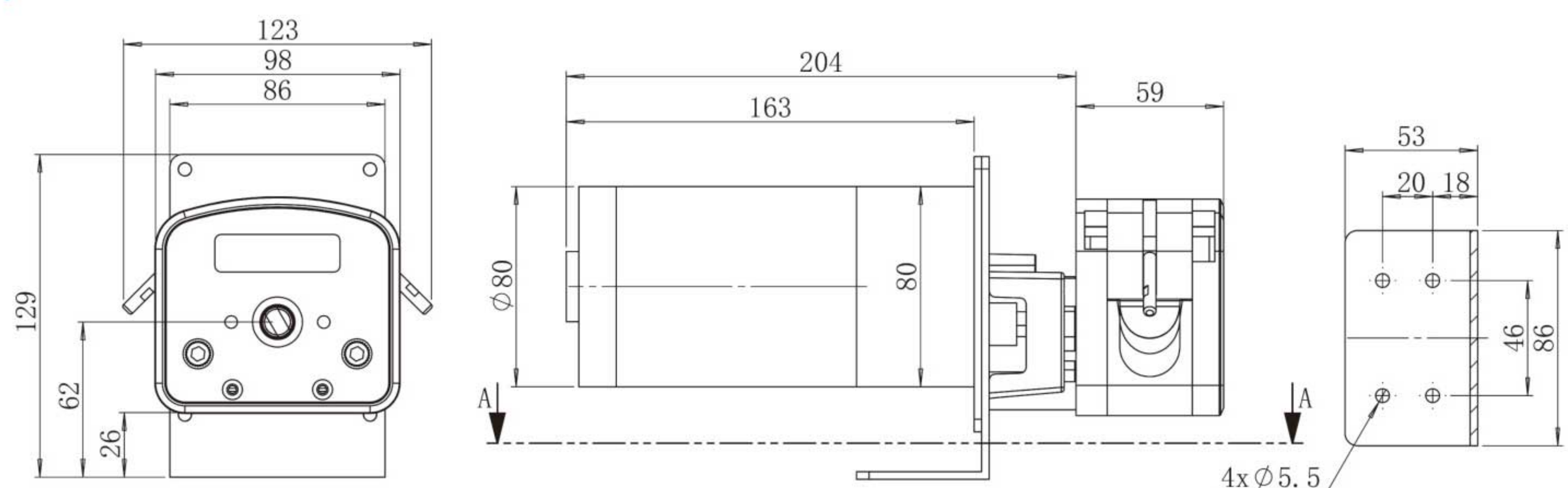

### OEM-Z402 Technical Specifications

Model No.	Motor type	Power supply	Power(W)	Speed(rpm)	Speed error	Working environment
OEM-Z402	DC geared motor	DC24V/2.5A	40	600	≤ ±10%	0-40°C, 80%RH

### OEM-JT12/DZ25-3L(AC speed motor)

Dimension Drawing(Unit: mm)

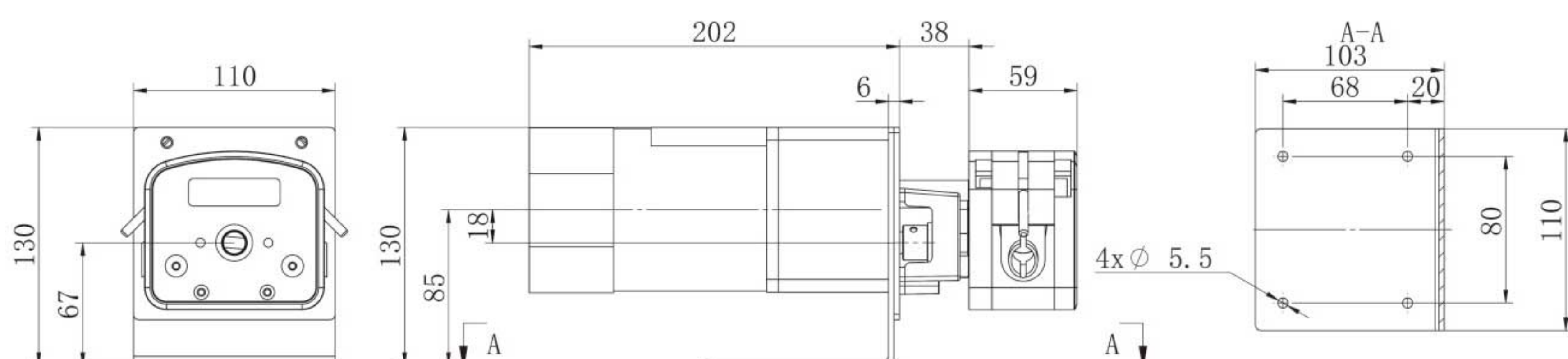

### OEM-JT12 Technical Specifications

Model No.	Motor type	Power supply	Power(W)	Speed(rpm)	Speed error	Working environment
OEM-JT12	AC speed motor	AC220V(standard), AC110V(optional)	60	43-430	≤ ±10%	0-40°C, 80%RH

